

VIBRATORY PARTS FEEDERS

Parts **orientation & handling** technologists



AYLESBURY AUTOMATION

*technology
in the
making*

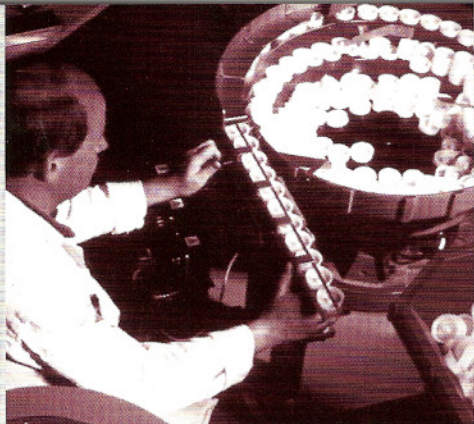

VIBRATORY PARTS FEEDERS

**Aylesbury Automation
has a special
understanding of
parts handling gained
through many years
of experience.
The Euro Series (SI)
vibratory feeding
system fully meets
all EU directives.
These and other
quality products
have made
Aylesbury Automation
a leading name in
factory automation.**



AYLESBURY AUTOMATION



AYLESBURY AUTOMATION

Parts Handling system technologists

Aylesbury Automation provides professional and economic solutions for parts handling requirements with the most appropriate and reliable technology available. A wide range of experience in parts handling systems enables Aylesbury Automation to suggest optimum solutions based on required output and flexibility which are both well designed and cost effective.

Feasibility, design and expert selection advice is offered from Aylesbury Automation's specialist team of application engineers. Alternatively, a fully tooled system can be provided to meet specific parts handling requirements.

Ordering information

Bowls	Type	Size	Rotation
example	SIS	250-32-OS	Clk

Drive Unit	Type	Vibration	Rotation
example	SI 250	-2	Clk

Control Box	Type	Supply Voltage	Supply Frequency
example	SIEC MK3	230v	50hz

Bowls (Euro series)

SIS Manufactured from cast aluminium - **OS** Oversize - **N** Negative flights.

	SIS	150-10	200-10	200-20-OS	200-19-N	250-20	250-32	250-32-OS	250-25-N	400-32	400-50
Dimensions	A	101	115	160	140	160	200	267	229	270	335
	B	10	10	20	19	20	32	32	25	32	50
	C	60	80	90	72	95	125	152	129	150	190
	D	53	64	70	38	75	90	110	102	110	140
	E	25	34	32	25	30	40	50	51	50	65
Effective capacity Ltrs		0.3	0.5	1	0.8	1	2	7	2	7	10
Drive Unit		SI 150		SI 200				SI 250			SI 400

SIC Fabricated from mild steel, stainless steel or to pharmaceutical standards.

	SIC	150-12-70	200-12-80	250-15-110	250-30-130	400-15-180	400-25-160	400-30-160	625-75-250	630-50-180	630-50-300
Dimensions	A	84	90	125	175	254	200	220	381	335	335
	B	12	12	15	30	15	25	30	75	50	50
	C	70	80	110	130	180	160	160	250	180	195
	D	64	65	73	120	107	107	141	167	156	167
	E	22	22	25	33	45	45	50	82	70	70
Effective capacity Ltrs		0.5	0.8	1.2	1.6	2	1.8	7	23	20	20
Drive Unit		SI 150	SI 200		SI 250		SI 400		SI 625		SI 630

SIK Fabricated from mild steel, stainless steel or to pharmaceutical standards.

	SIK	200-18-55	250-20-90	250-20-115	250-8-150	400-50-160	400-15-220	400-50-190	630-50-180	630-50-190
Dimensions	A	133	202	208	240	335	372	335	449	449
	B	18	20	20	8	50	15	50	50	50
	C	55	90	115	150	160	220	190	180	190
	D	47	77	111	138	153	169	180	172	167
	E	25	32	32	40	68	71	68	70	70
Effective capacity Ltrs		0.5	2	2	2	10	10	10	20	20
Drive Unit		SI 200		SI 250			SI 400		SI 630	

SIC/SIK Bowls can be manufactured to suit individual customer requirements.

Vibratory drive units (Euro series)

	SI	150	200	250	400	625	630
Dimensions	A	152	180	310	460	610	680
	B	140	184	247	267	425	260
	C	130	165	233	247	405	235
	D	200	215	360	510	750	750
	E	176	198	310	460	690	690
	F	6.5	7	11	11	13	13
Weight Kg		9	13	49	116	251	180
Current Consumption VA		220	308	726	803	950	990

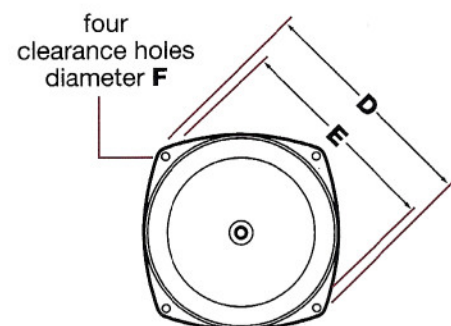

Electrical Data

Vibration frequency						
50 Hz	n/a	n/a	n/a	400-1	625-1	630-1
100 Hz	150-2	200-2	250-2	400-2	n/a	n/a

Drive units are manufactured for either **Clock** or **Counter Clockwise** feeding.
Please specify when ordering.

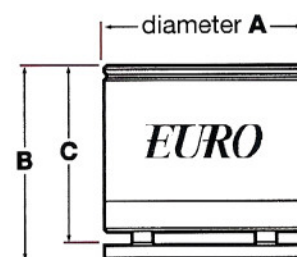

400-38-N	625-50	625-75	625-75-N	625-60-N	630-50	630-65
305	381	381	381	381	440	440
38	50	75	75	60	50	65
159	192	152	193	220	220	230
110	140	105	150	110	155	157
55	110	102	102	87	77	95
7	18	15	15	16	25	25
SI 625				SI 630		

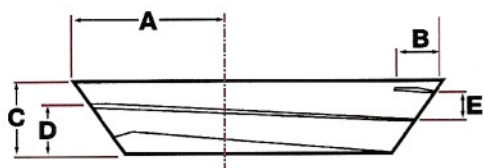
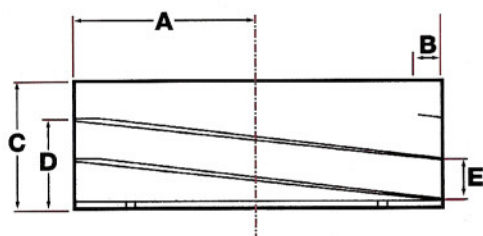
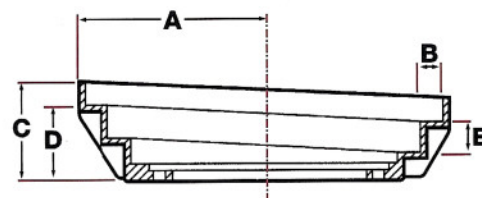

Bowl lining

The following linings are available to increase durability:

Metaline & Textured Metaline

Available in red (standard)

White (pharmaceutical & FDA approved)

Heavy Duty Black Polyurethane
Directional fibre

Grey Fibre
Habisat

Control boxes

SERIES SIEC MK3 / MK3T / DIGITAL 6A / 12A

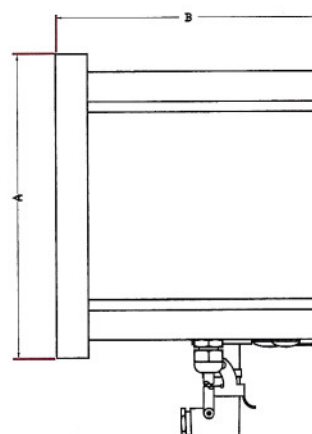
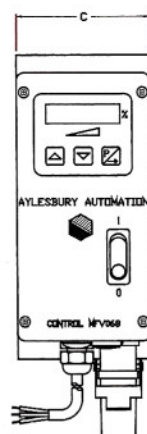
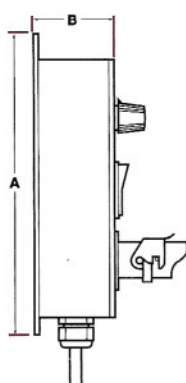
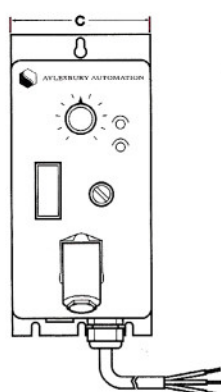

SERIES MK3T & DIGITAL boxes incorporate an adjustable two way timer for feed track control with optional sensing heads.

Control Box Type	SIEC MK3	SIEC MK3T	DIGITAL 6A	DIGITAL 12A
Dimensions A	205	205	205	205
B	50	105	180	208
C	90	90	90	160
Input voltage	110v/230v	110v/230v	110v or 230v	110v/230v
Input frequency	50/60Hz	50/60Hz	50/60Hz	50/60Hz

Acoustic enclosures

SERIES SIAE

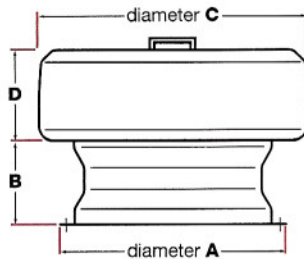

SIAE	250	250-OS	400	630
Dimensions A	565	565	725	940
B	220	220	285	240
C	560	675	820	1200
D	225	225	270	325
Weight Kg	20	22	25	37

Acoustic (soundproof) enclosures are designed to fit SI 250, 400 and 630 drive units. Typically, they can reduce noise levels by 10-15dB(A). An adaptor plate is required when used in conjunction with a Series SIST stand.

Stands

SERIES SIST

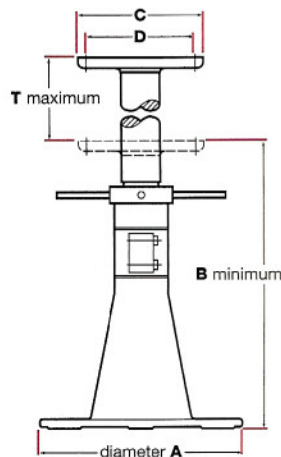

SIAE	250*	400*	630*
Dimensions A	400	400	630
Min B	*	*	*
Max T	250	250	250
Top plate C	250	380	550
D	220	325	488
Min weight Kg	60	65	85

Stands are available for SI 250, 400 and 630 drive units in three height ranges.

*These three suffixes denote minimum height (mm): **-600 -800 -1000**.

Each is available with a plain, (P) fixed height column or with an adjustable, threaded (T) height column.

Eg. **400-800T** is an adjustable stand with a minimum height of 800mm made to fit an SI 400 drive unit.

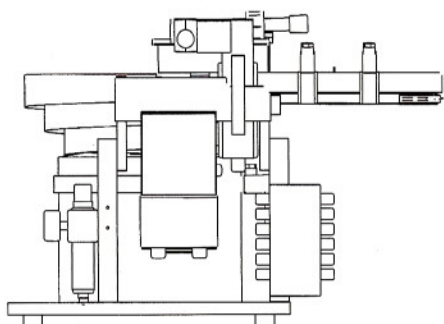
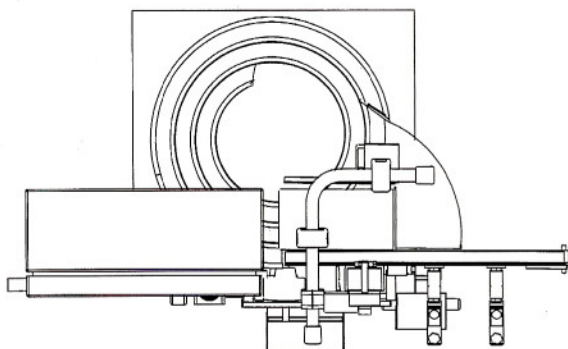

Euroscan

The Aylesbury Automation SV1 is a complete compact feeding, orientating, sorting and inspection device mounted on a base plate, consisting of a bowl feeder (3 sizes available), a conveyor belt with integrated camera system and a brand-name computer.

Parts That Can Be Sorted

Generally all parts that can be transported in stable positions, preferably rotationally symmetrical parts.

Approx Dimensions: Length 3mm - 78mm
Height 0.5mm - 25mm
Width 0.5mm - 22mm

Programming by teach-in procedure (select a part, let it pass by the camera, start the device)

Individual data sheets are available for all products.

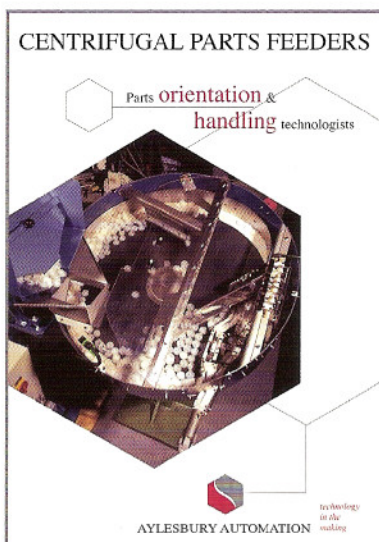
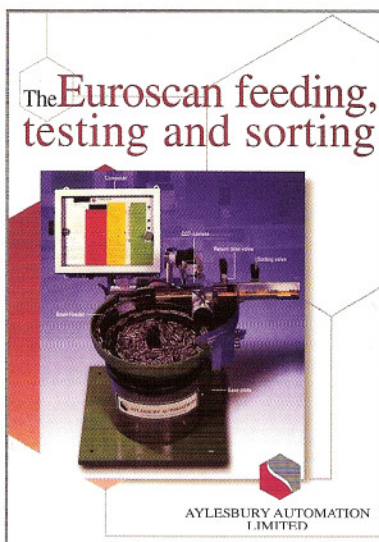
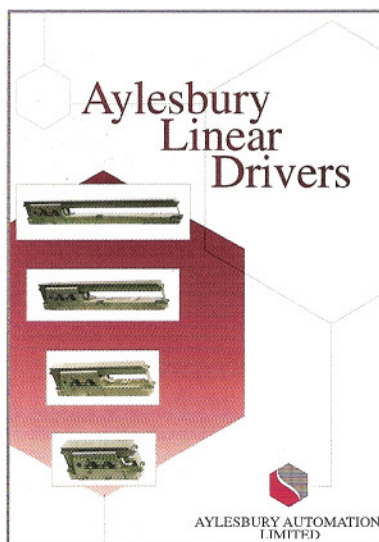
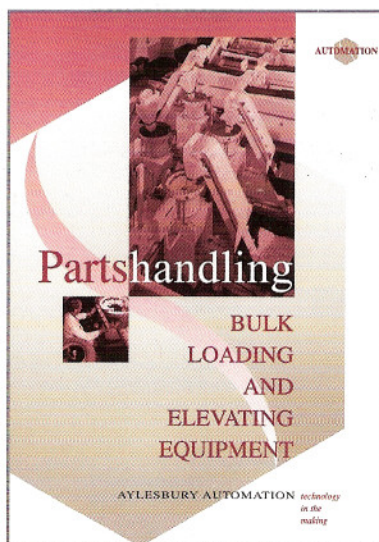
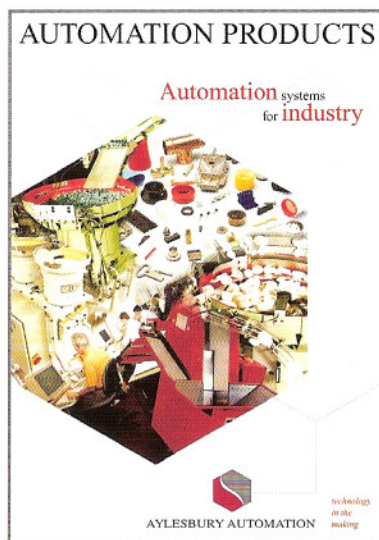
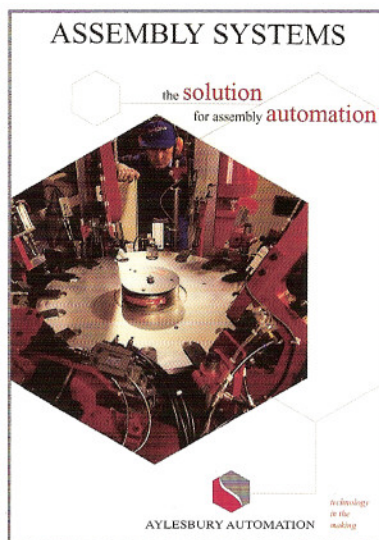

ISO 9001:2000
FM 00034



AYLESBURY AUTOMATION LIMITED

Farmbrough Close, Stocklake Industrial Park, Aylesbury, Buckinghamshire HP20 1DQ
Telephone: 01296 314300 Fax: 01296 482424



INVESTOR IN PEOPLE

A S S E M B L Y T E C H N O L O G I S T S